

aalco®

2017

ABRIDGED

Ver. 1

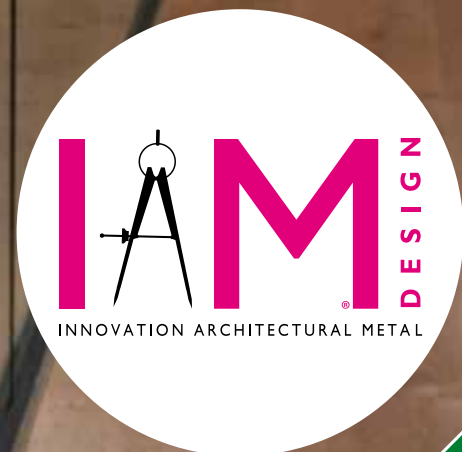



glassu® *Design solutions for glass railings*

GLASSU is a **modular systems selection to create glass railings** (without struts) for stairs and balconies, liable **to floor or wall anchoring**; it is suitable both for interiors and exteriors, both for **private** and **public** places (high traffic places, too). Every GLASSU product is studied to meet technician demands: IAM Design creates a fastening system that supports the installation and a stands and complementary covering elements selection which are ready to be assembled. With just a few actions, the fastening procedure guarantees great executive precision and reduced installing time. Glass fasten wedges system guarantees complete security in fastening the sheet to the profile.

Easy and fast installation

Designed in synergistically with qualified technicians. Every phase in the assembly turns out to be easy and clear. To make a mistake would be impossible!

High versatility

Thanks to its minimal design, GLASSU systems are suitable to every location, both contemporary and classic. At the same time, the wide accessories selection allows a project to meet all sorts of technical and construction demands. "U" metallic profiles characterize the entire selection and have a floor and wall anchoring system: what's more, wall anchoring gets really useful when it is necessary to exploit space available on stairs, landings or terraces.

Glass and customization

The main element of GLASSU balconies is the glass, case-hardened and stratified. What does it actually mean? High rigidity, fragments containment in case of breakage, UV protection, edges stability, soundproofing and transparency customization (with extraclear or clear color finishes).

To get a higher resistance, especially in well frequented public spaces, stratified glass is available.



Copyright © 2017 Ind.i.a. spa. Tutti i diritti riservati. Domanda di marchio, design o brevetto depositata/registrazione o brevetto rilasciato in uno o più paesi. Per ulteriori informazioni, non esitare a contattarci a info@iamdesign.com.
Copyright © 2017 Ind.i.a. spa. All rights reserved. Trademark, design or patent application pending/registration or patent granted in one or more countries. For additional information, please contact us at info@iamdesign.com.



design load 2.25 kN ultimate strength 4.5 kN

2 kN F FLOOR FIXING PROFILE

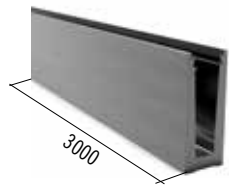

Aluminium support for floor anchorage

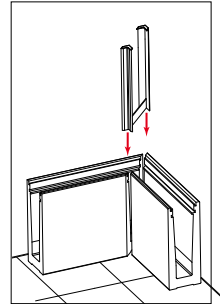
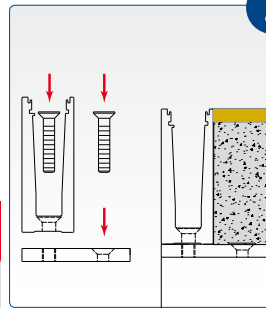
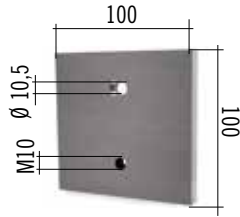

ALUMINIUM
E1800130

ALUMINIUM
E1800215

IRON - ZINC
E1800360

AISI316
E1999001

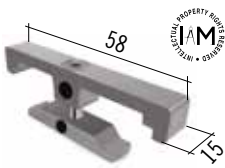

AISI316
E1800240

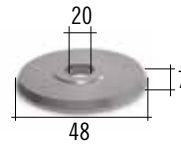
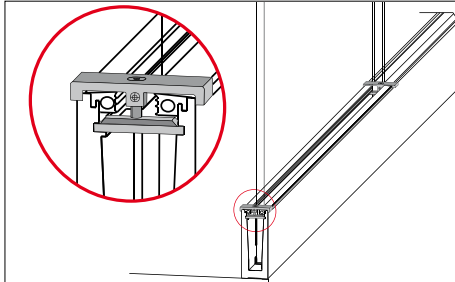

ALUMINIUM
E1800350

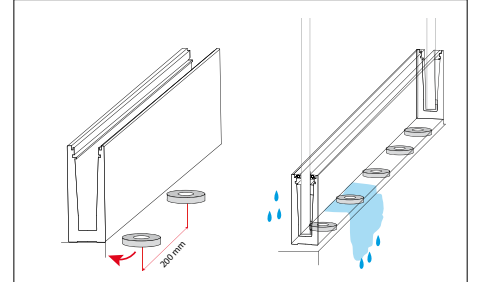

design load 2.25 kN ultimate strength 4.25 kN

2 kN W WALL FIXING PROFILE

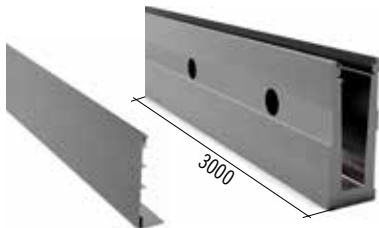

Aluminium support for wall anchorage

ALUMINIUM
E1800140



AISI316
E1999002

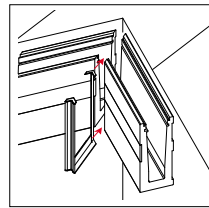

AISI316
E1999003

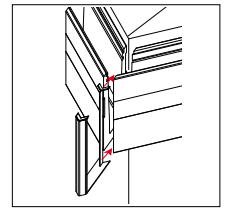

GLASS FIXING ACCESSORIES



Description
E40588 Tool for insertion and removal of the wedges from the profile

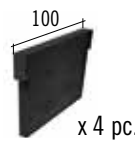
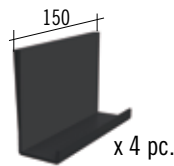

Fixing kit for 1 metre baluster

PLASTIC	Glass thickness
E1804600	12.76 mm
E1807600	13.52 mm
E1808600	15 mm
E1809600	16.76 mm
E1805600	17.52 mm
E1810600	19 mm
E1806600	20.76 - 21.52 mm

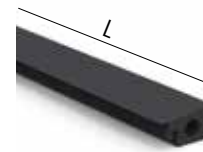

Closing gaskets

RUBBER	Glass thickness	L
E1804620	12.76-13.52 mm	30 m
E1803620	16.76-17.52 and 19 mm	30 m
E1806620	20.76 e 21.52 mm	30 m

For 15-mm-thick glass, use the rubbers as shown in the graphic.

side A E1804620
side B E1803620

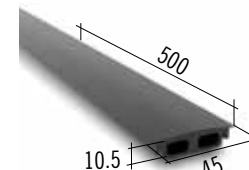
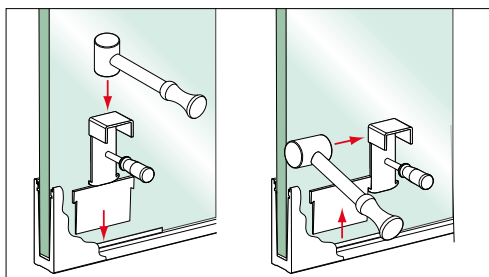

RUBBER
E1999004

YOU CAN CUT IT OBTAINING YOUR CUSTOM-MADE SPACERS

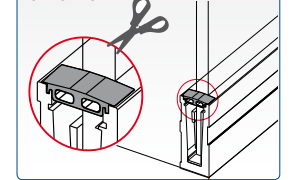

FLOOR ANCHORAGE INSTALLATION

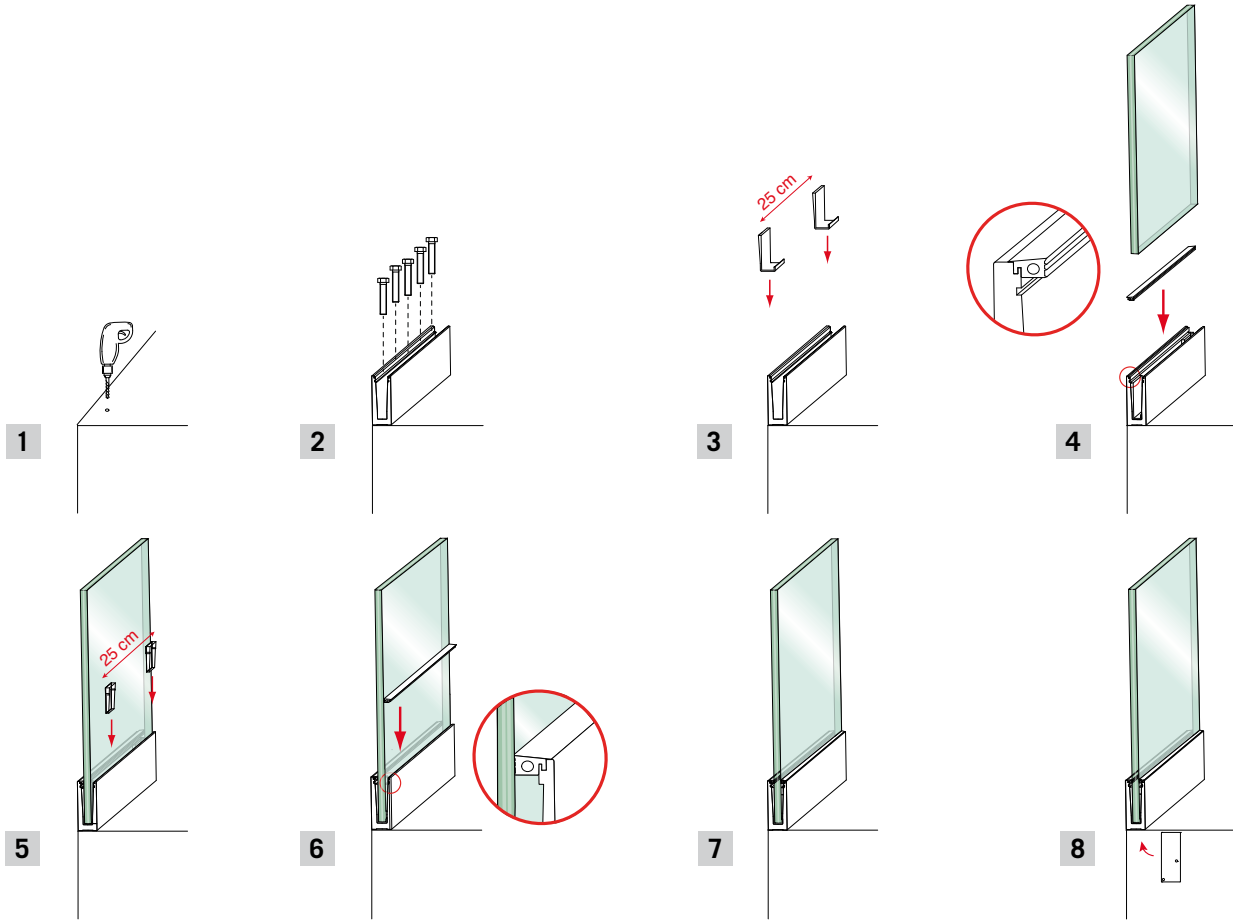

WALL ANCHORAGE INSTALLATION

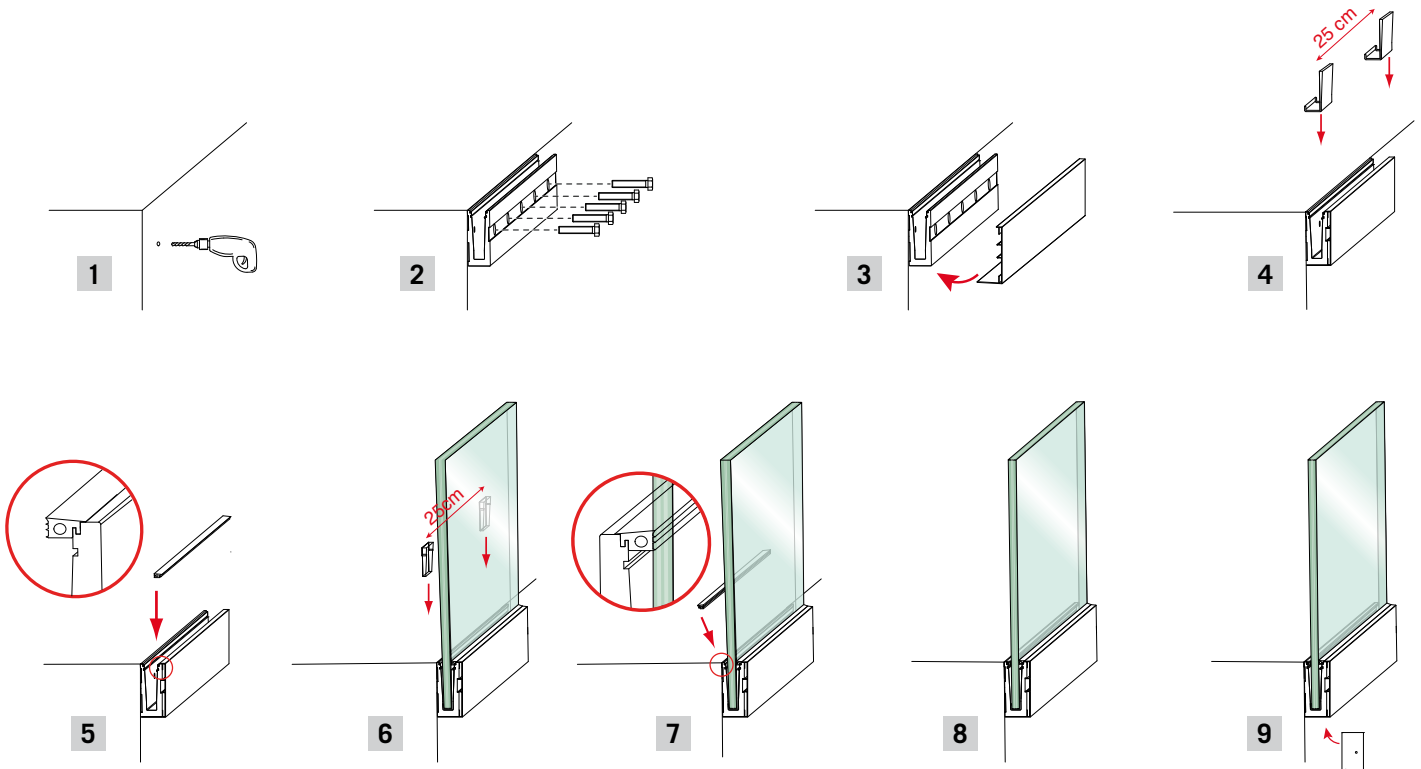

design load 2.25 kN

ultimate strength 4.5 kN

2 kN L FLOOR FIXING PROFILE



Aluminium support for floor anchorage

ALUMINIUM
E1800170

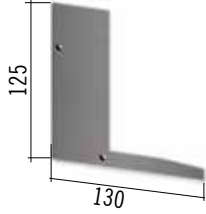

ALUMINIUM
E1800217



ALUMINIUM
E1800345

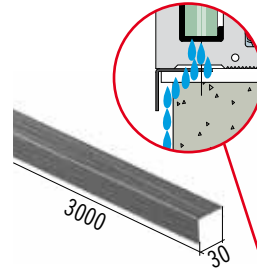

ALUMINIUM
E1800355

Art. E1800355 can be used to hide the spaces created by the thickness due to the water drainer

It covers the damages that might be present on the edges of the concrete bearing structure

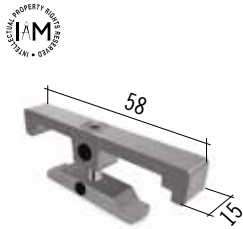

AISI316
E1800240

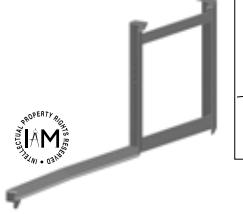
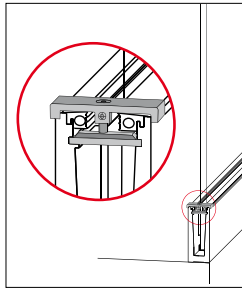

AISI316
E1999005

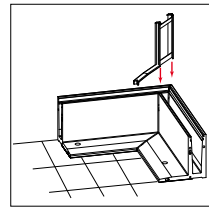

AISI316
E1999006

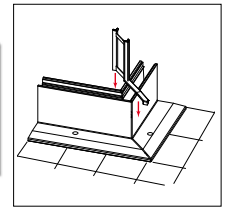

GLASS FIXING ACCESSORIES



Description
E40588 Tool for insertion and removal of the wedges from the profile

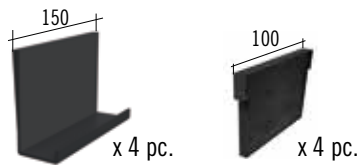
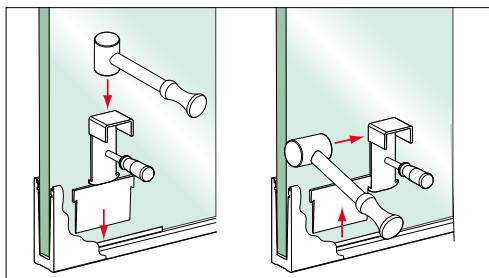

PLASTIC	Glass thickness
E1804600	12.76 mm
E1807600	13.52 mm
E1808600	15 mm
E1809600	16.76 mm
E1805600	17.52 mm
E1810600	19 mm
E1806600	20.76 - 21.52 mm

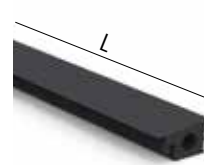

RUBBER	Glass thickness	L
E1804620	12.76-13.52 mm	30 m
E1803620	16.76-17.52 and 19 mm	30 m
E1806620	20.76 e 21.52 mm	30 m

For 15-mm-thick glass, use the rubbers as shown in the graphic.

side A E1804620
side B E1803620

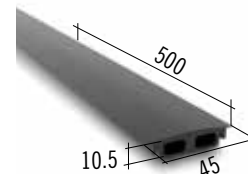

RUBBER
E1999004

YOU CAN CUT IT OBTAINING YOUR CUSTOM-MADE SPACERS



FLOOR ANCHORAGE INSTALLATION

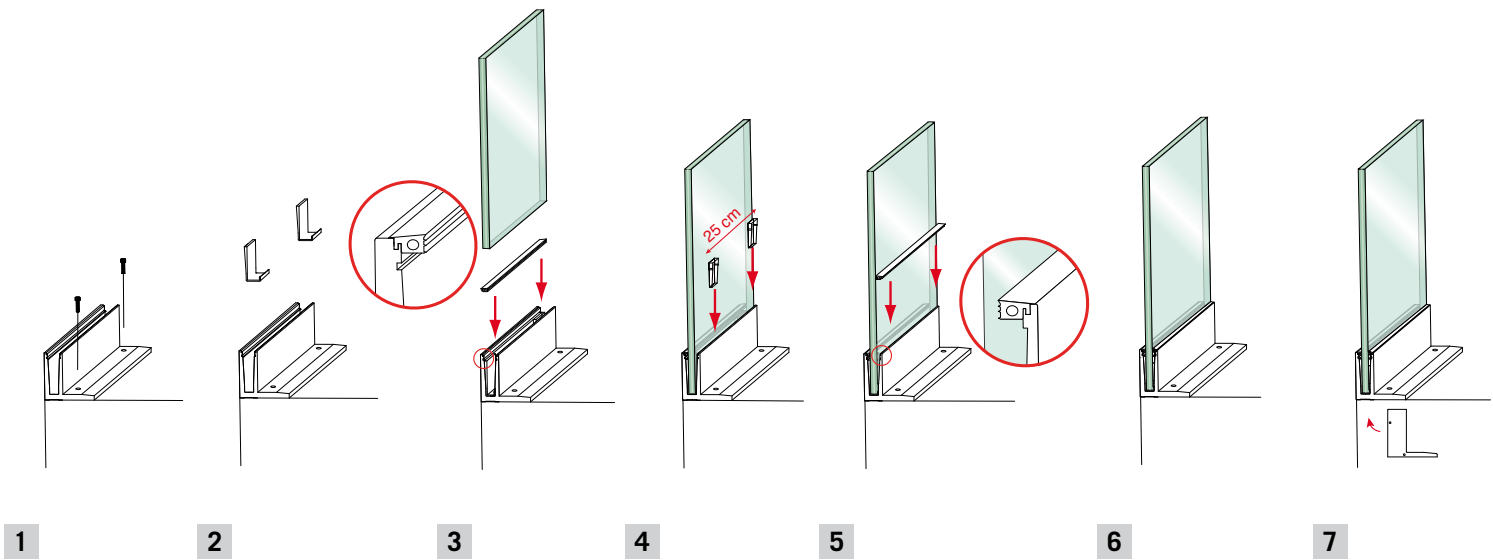

design load 3.5 kN ultimate strength 5.5 kN 3 kN FLOOR FIXING PROFILE



ALUMINIUM	Description
E1800120	Aluminium support for floor anchorage



ALUMINIUM	Description
E1800210	

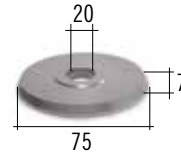

ALUMINIUM	Description
E1800340	

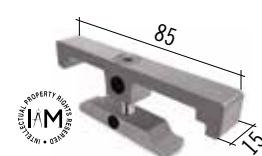

AISI316	Description
E1800220	



GALVANISED IRON	Description
E1800340	

design load 3.5 kN ultimate strength 5.5 kN 3 kN WALL FIXING PROFILE

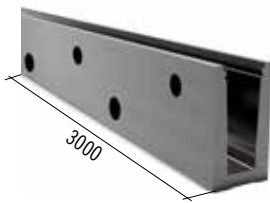

ALUMINIUM	Description
E1800115	Aluminium support for wall anchorage

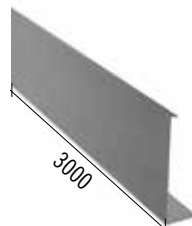

ALUMINIUM	Description
E1800330	



ALUMINIUM	Description
E1800210	



GALVANISED IRON	Description
E1800300	



GALVANISED IRON	Description
E1800500	

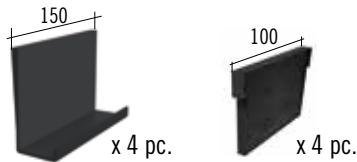

Fixing kit for 1 metre baluster

PLASTIC	Glass thickness
E1801600	20.76 and 21.52 mm
E1802600	24.76 and 25.52 mm
E1803600	31.52 mm

GLASS FIXING ACCESSORIES

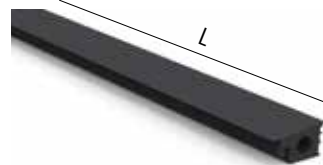

Closing gaskets

RUBBER	Glass thickness	L
E1801620	20.76 and 21.52 mm	30 m
E1802620	24.76 and 25.52 mm	30 m
E1803620	31.52 mm	30 m



	Description
E40588	Tool for insertion and removal of the wedges from the profile



FLOOR ANCHORAGE INSTALLATION

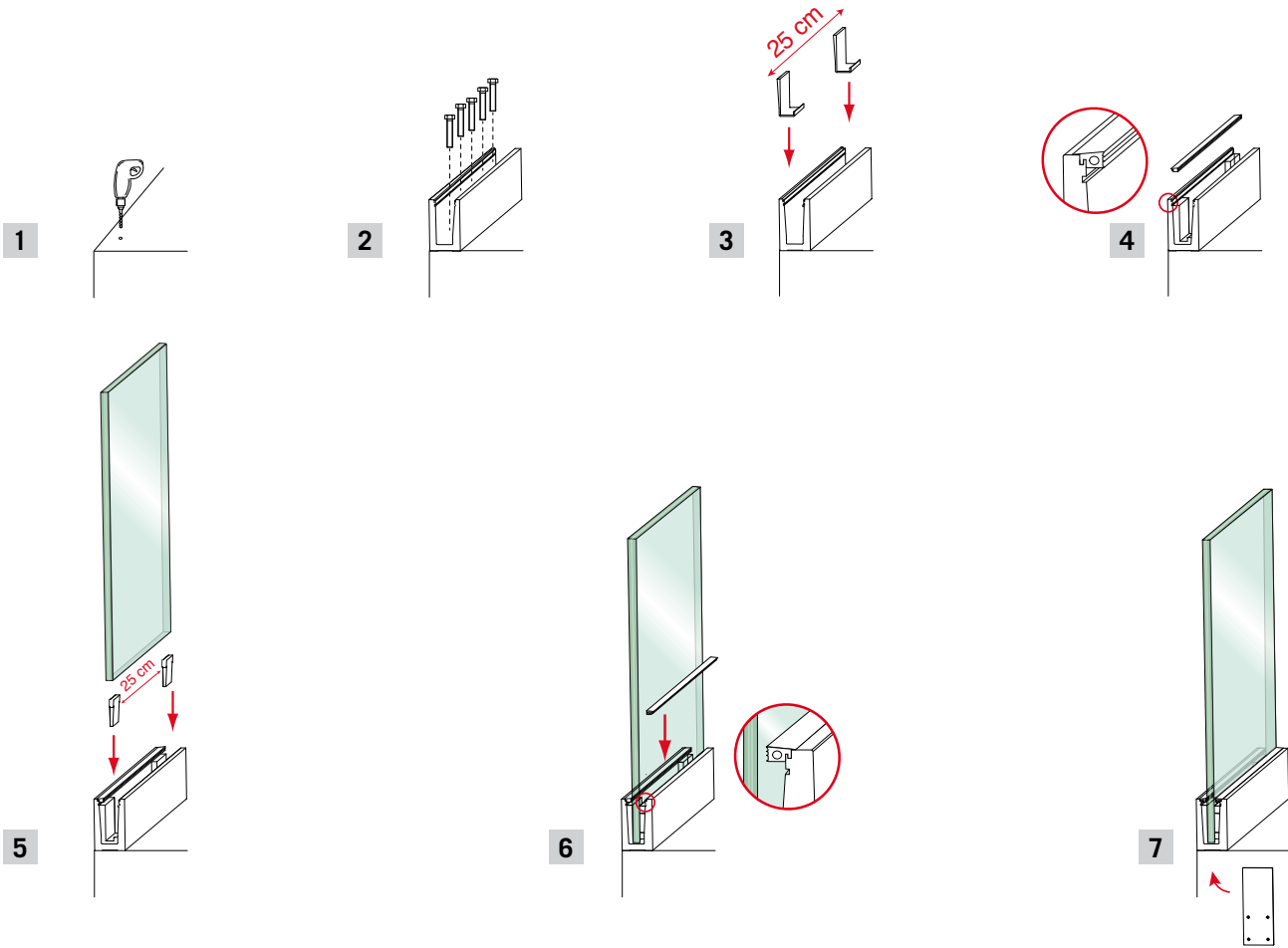

WALL ANCHORAGE INSTALLATION

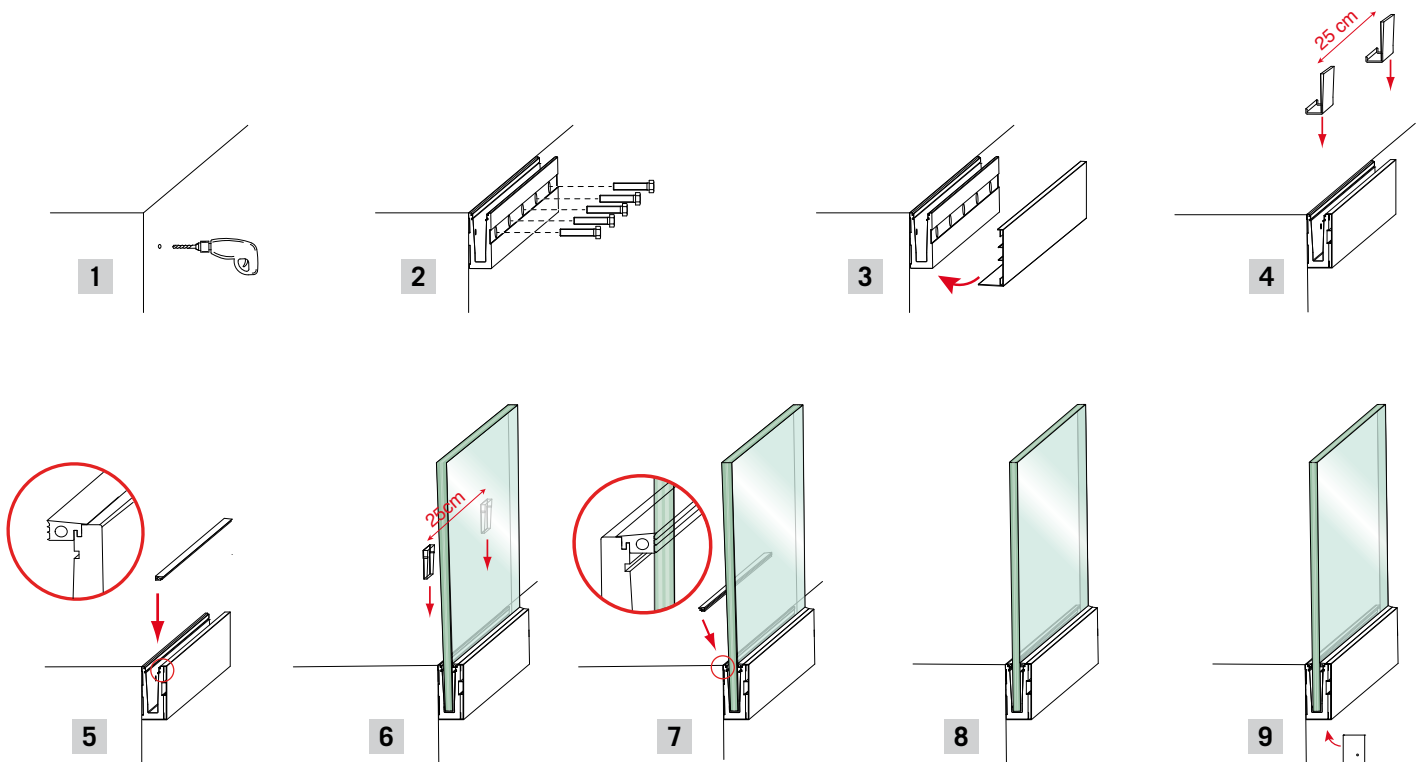

NEW

• Handrail Support made by casting

For 2017, IAM Designs presents new cast-made handrail supports

Why cast-made?

With no mechanical joints, they are ideal for outside installations on highly sea salty environments

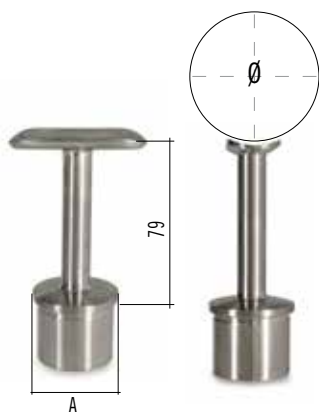
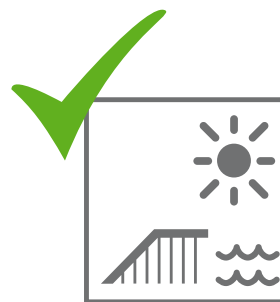

Fixed Handrail support

AISI316	For tube A	Ø
E033610009	Ø 42.4 x 2.5 mm	Ø 42.4 mm
E033610011	Ø 48.3 x 2.0 mm	Ø 48.3 mm
E033610012	Ø 48.3 x 2.5 mm	Ø 42.4 mm
E033610013	Ø 48.3 x 2.5 mm	Ø 48.3 mm



For 2017, IAM Design presents the new posts with reinforced base for a higher resistance and security.

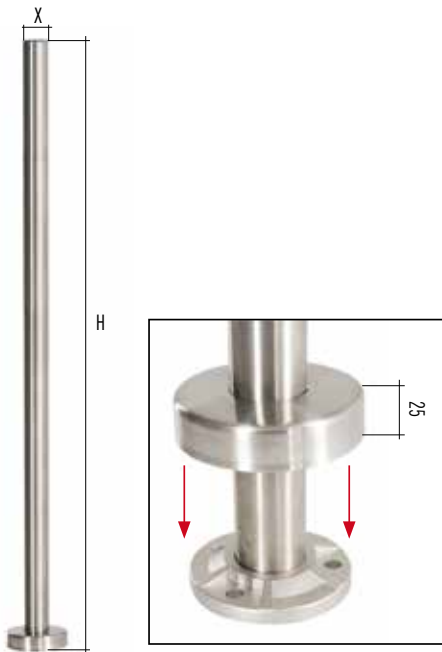

AISI316	X	H
E033610014	42.4 x 2.0 mm	1000 mm
E033610015	42.4 x 2.6 mm	1000 mm
E033610016	48.3 x 2.0 mm	1000 mm
E033610017	48.3 x 2.6 mm	1000 mm





AISI304	AISI316	Tube
E1000424	E1000424	Ø 42.4 x 1.5 x 6000 mm
E1000483	E1100483	Ø 48.3 x 1.5 x 6000 mm



AISI316	Tube
E1500100	Ø 42.4 x 1.5 mm
E1500110	Ø 48.3 x 1.5 mm



AISI316	Tube
E1400100	Ø 42.4 x 1.5 mm
E1400110	Ø 48.3 x 1.5 mm



AISI316	Tube
E1200100	Ø 42.4 x 1.5 mm
E1200110	Ø 48.3 x 1.5 mm



AISI316	Tube
E1510100	Ø 42.4 x 1.5 mm
E1510110	Ø 48.3 x 1.5 mm



AISI316	Tube
E1520100	Ø 42.4 x 1.5 mm
E1520110	Ø 48.3 x 1.5 mm



AISI316	Tube
E1100100	Ø 42.4 x 1.5 mm
E1100110	Ø 48.3 x 1.5 mm



AISI316	Tube
E1110100	Ø 42.4 x 1.5 mm
E1110110	Ø 48.3 x 1.5 mm



Also available in groups of 6 metres

RUBBER	Tube	Glass	Coil length
E1999100	Ø 42.4 mm	8 - 10.76 mm	24 m
E1999200	Ø 42.4 mm	12 - 16.76 mm	24 m
E1999300	Ø 42.4 mm	16.76 - 18 mm	24 m
E1999400	Ø 48.3 mm	8 - 12.76 mm	24 m
E1999500	Ø 48.3 mm	13 - 17.52 mm	24 m
E1999650	Ø 48.3 mm	18 - 21.52 mm	24 m



Art. no.	Description
E4052	Protective spray that leaves an anti-static and water repellent finish

Art. no.	Description
E4054	High strength adhesive finish



Ask for our complete catalogue

www.aalco.co.uk

EASY TO INSTALL

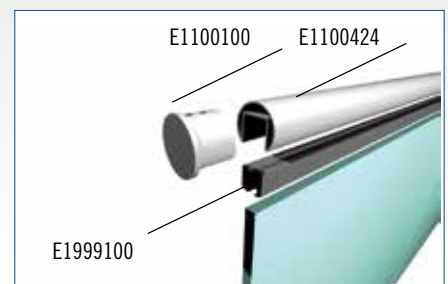

IAM Design's range includes many clamps in different shapes and sizes to suit different designs and installations. They are available in a range of materials: AISI316, AISI304, Zamac and, upon request, polished mirror finish. They are provided with SEPARATE RUBBERS to match the clamp with the correct rubber for the glass thickness specified. Being a modular system, it enables the combining of different elements to obtain the most suitable result for any project. The coding of the components reflects this modularity and makes it easy to identify the different features.



HOW TO READ THE GLASS CLAMPS' CODES

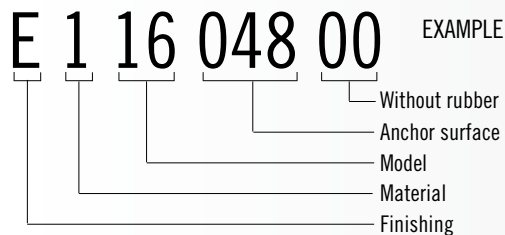

HOW TO READ THE CODES OF THE GLASS CLAMPS' RUBBERS

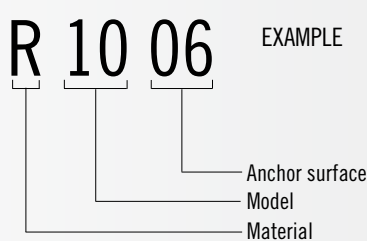

MOD. 10

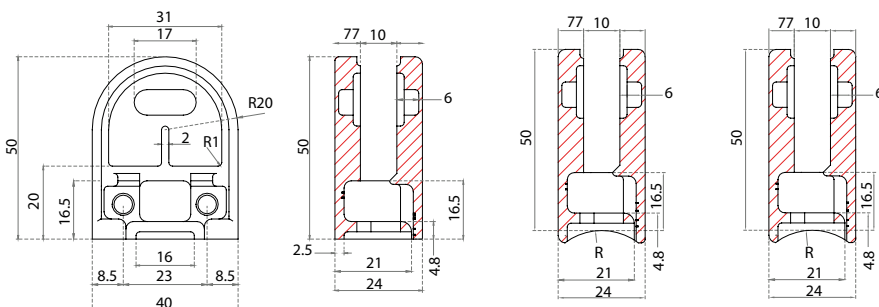

Glass clamps are supplied without rubbers in boxes of 4



AISI304 SATIN	For tube Dia.	R
E 1 10 000 00	Flat surface	-
E 1 10 033 00	33.7 mm	16.8 mm
E 1 10 042 00	42.4 mm	21.2 mm

AISI316 SATIN	For tube Dia.	R
E 2 10 000 00	Flat surface	-
E 2 10 033 00	33.7 mm	16.8 mm
E 2 10 042 00	42.4 mm	21.2 mm

RUBBER	MOD.	Nr. Set	Nr. per Set	Glass thick.
R 10 06	10	4	2 pcs.	6 mm
R 10 08	10	4	2 pcs.	8 mm

MOD. 11

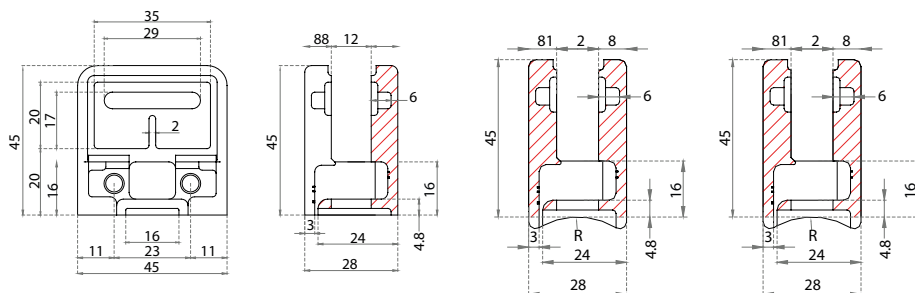

Glass clamps are supplied without rubbers in boxes of 4



AISI304 SATIN	For tube Dia.	R
E 1 11 000 00	Flat surface	-
E 1 11 042 00	42.4 mm	21.2 mm
E 1 11 048 00	48.3 mm	24.15 mm

AISI316 SATIN	For tube Dia.	R
E 2 11 000 00	Flat surface	-
E 2 11 042 00	42.4 mm	21.2 mm
E 2 11 048 00	48.3 mm	24.15 mm

RUBBER	MOD.	Nr. Set	Nr. per Set	Glass thick.
R 11 06	11	4	2 pcs.	6 mm
R 11 08	11	4	2 pcs.	8 mm
R 11 10	11	4	2 pcs.	10 mm

MOD. 12



With locking pin

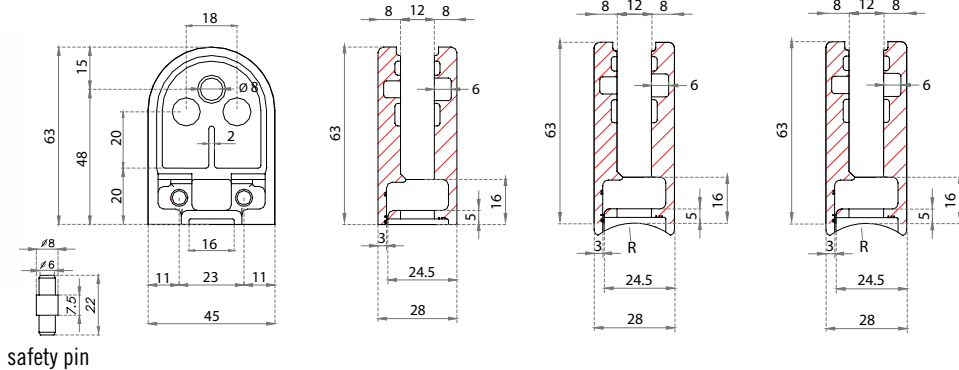

safety pin

Glass clamps are supplied without rubbers in boxes of 4



AISI304 SATIN				For tube Dia.	R
E	1	12	000 00	Flat surface	-
E	1	12	042 00	42.4 mm	21.2 mm
E	1	12	048 00	48.3 mm	24.15 mm

AISI316 SATIN				For tube Dia.	R
E	2	12	000 00	Flat surface	-
E	2	12	042 00	42.4 mm	21.2 mm
E	2	12	048 00	48.3 mm	24.15 mm

RUBBER	MOD.	Nr. Set	Nr. per Set	Glass thick.
R 12 06	12	4	2 pcs.	6 mm
R 12 08	12	4	2 pcs.	8 mm
R 12 10	12	4	2 pcs.	10 mm

MOD. 13



With locking pin

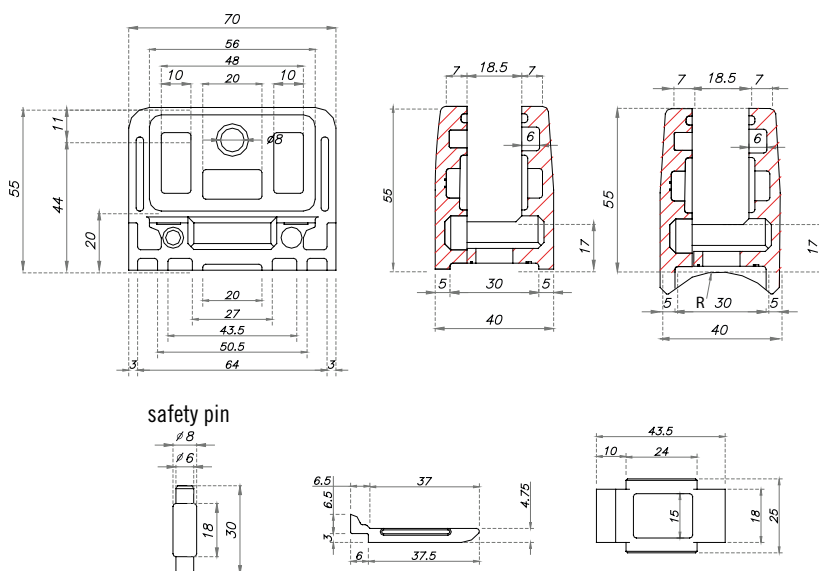

safety pin

Glass clamps are supplied without rubbers in boxes of 4



AISI304 SATIN				For tube Dia.	R
E	1	13	000 00	Flat surface	-
E	1	13	048 00	48.3 mm	24.15 mm

AISI316 SATIN				For tube Dia.	R
E	2	13	000 00	Flat surface	-
E	2	13	048 00	48.3 mm	24.15 mm

RUBBER	MOD.	Nr. Set	Nr. per Set	Glass thick.
R 13 12	13	4	2 pcs.	12 mm
R 13 15	13	4	2 pcs.	15 mm

i

TO COMPLETELY ELIMINATE THE POSSIBILITY OF GLASS SLIDING USE THE SUPPLIED ACCESSORY THAT CAN BE USED ON BOTH SIDES

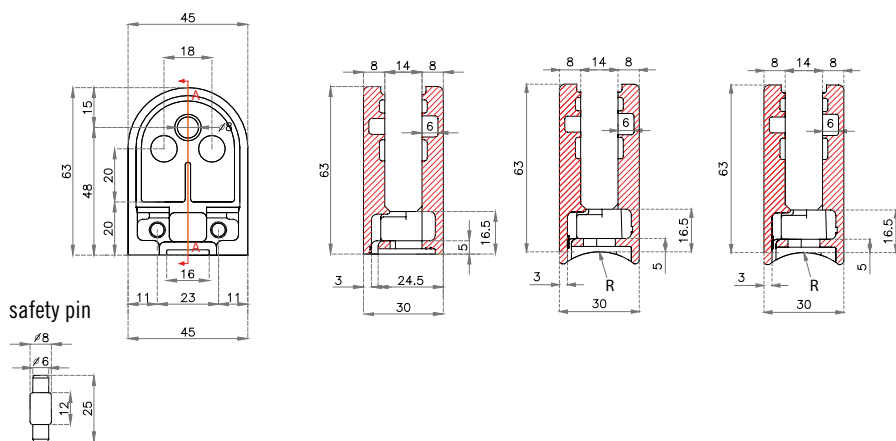

With locking pin

Glass clamps are supplied without rubbers in boxes of 4



Monolithic glass

AISI304 SATIN				For tube Dia.	R
E	1	14	000 00	Flat surface	-
E	1	14	042 00	42.4 mm	21.2 mm
E	1	14	048 00	48.3 mm	24.15 mm

AISI316 SATIN				For tube Dia.	R
E	2	14	000 00	Flat surface	-
E	2	14	042 00	42.4 mm	21.2 mm
E	2	14	048 00	48.3 mm	24.15 mm

RUBBER	MOD.	Nr. Set	Nr. per Set	Glass thick.
R 14 12	14	4	2 pcs.	12 mm

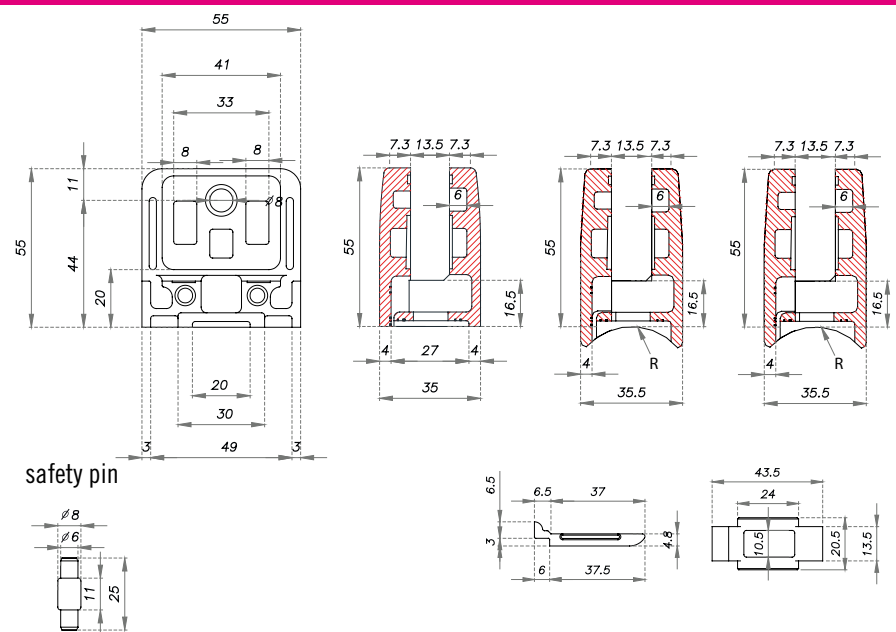

With locking pin

* Glass clamps are supplied without rubbers in boxes of 4



Monolithic glass

AISI304 SATIN				For tube Dia.	R
E	1	15	000 00	Flat surface	-
E	1	15	*042 00	42.4 mm	21.2 mm
E	1	15	048 00	48.3 mm	24.2 mm

AISI316 SATIN				For tube Dia.	R
E	2	15	000 00	Flat surface	-
E	2	15	*042 00	42.4 mm	21.2 mm
E	2	15	048 00	48.3 mm	24.2 mm

RUBBER	MOD.	Nr. Set	Nr. per Set	Glass thick.
R 15 08	15	4	2 pcs.	8 mm
R 15 10	15	4	2 pcs.	10 mm
R 15 12	15	4	2 pcs.	12 mm

TO COMPLETELY ELIMINATE THE POSSIBILITY OF GLASS SLIDING USE THE SUPPLIED ACCESSORY THAT CAN BE USED ON BOTH SIDES



B

AISI316	Dimensions	Glass thickness
Satin Finish		
E00840	Ø 60 mm	8 mm
Mirror Polished		
X00840	Ø 60 mm	8 mm



Satin-finish stainless steel fitting for use when panel is fixed to one side only

AISI316
Satin Finish
E00840/C
Mirror Polished
X00840/C



Adapter to be inserted on round clamp

AISI316	For tube
E00841	Ø 33.7 mm
E00845	Ø 38.1 mm
E00842	Ø 42.4 mm
E00844	Ø 48.3 mm
E00843	Flat surface

2 pieces in a set

To use with these article numbers:
E00820 - E00821 - E00820316 - E00821316
- E00830 - E00831 E00830316 - E00831316
- E00840

RUBBER	Glass
E00840/R1	8.76 mm
E00840/R2	10 mm
E00840/R3	10.76 mm
E00840/R4	12 mm
E00840/R5	12.76 mm



B

- 2 side fixing plates
- 1 set of one-layer rubbers for glass
- 1 set of two-layer rubbers for glass
- 4 M6 screws

AISI304	AISI316	Glass thickness
E0099100	E0099	Adjustable

Adapters to combine with side plates.
Stainless steel pin included

AISI316	For tube	Glass thickness
E99P8	Flat surface	8 - 8.76 mm
E9933P8	Ø 33.7 mm	8 - 8.76 mm
E9942P8	Ø 42.4 mm	8 - 8.76 mm
E9950P8	Ø 50.8 mm	8 - 8.76 mm
E99P10	Flat surface	10 - 10.76 mm
E9933P10	Ø 33.7 mm	10 - 10.76 mm
E9942P10	Ø 42.4 mm	10 - 10.76 mm
E9950P10	Ø 50.8 mm	10 - 10.76 mm
E99P12	Flat surface	12 - 12.76 mm
E9933P12	Ø 33.7 mm	12 - 12.76 mm
E9942P12	Ø 42.4 mm	12 - 12.76 mm
E9950P12	Ø 50.8 mm	12 - 12.76 mm

AISI316	For tube	Glass thickness
E99P16	Flat surface	16.76 - 17.52
E9942P16	Ø 42.4 mm	16.76 - 17.52
E9950P16	Ø 50.8 mm	16.76 - 17.52
E99P20	Flat surface	20.76 - 21.52
E9942P20	Ø 42.4 mm	20.76 - 21.52
E9950P20	Ø 50.8 mm	20.76 - 21.52

8 + 8
10 + 10

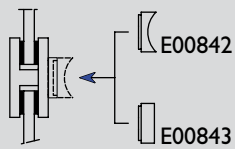

• The interchangeable clamp can be used with almost any tube!

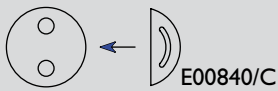

• Lateral locking converts clamp on one side only

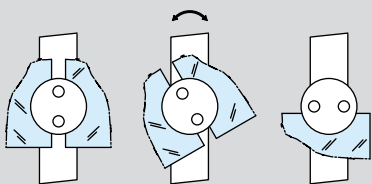

• The clamp can be rotated to meet the angle required

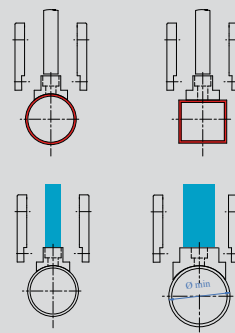

• The interchangeable clamp can be used with almost any tube!

• Maximum thickness of the glass depends on the width of the anchoring profiles

• EASY TO INSTALL • ECONOMICAL • SAFE

• EASY TO INSTALL • ECONOMICAL • SAFE



AISI304	AISI316	H	Diameter D	Glass thickness
E40930304	E40930	10 mm	30 mm	8 -16.76 mm

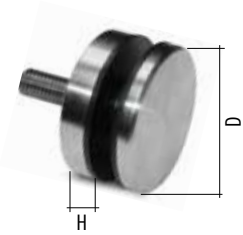

AISI316	H	Diameter D	Glass thickness
E40940	10 mm	50 mm	8 -16.76 mm

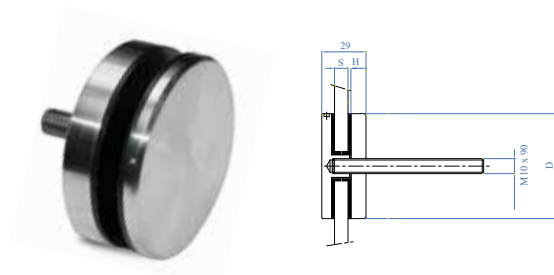

AISI316	H	Diameter D	Glass thickness
E40960	10 mm	60 mm	8 -16.76 mm

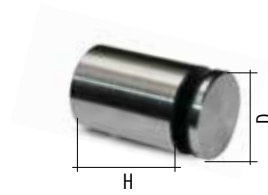

AISI304	AISI316	H	Diameter D	Glass thickness
E40900304	E40900	40 mm	30 mm	8 -16.76 mm
E40901304	E40901	50 mm	30 mm	8 -16.76 mm
E40902304	E40902	60 mm	30 mm	8 -16.76 mm



AISI316	H	Diameter D	Glass thickness
E40910	40 mm	50 mm	8 -17.52 mm
E40911	50 mm	50 mm	8 -17.52 mm
E40912	60 mm	50 mm	8 -17.52 mm



AISI316	H	Diameter D	Glass thickness
E40920	40 mm	60 mm	8 -17.52 mm
E40921	50 mm	60 mm	8 -17.52 mm
E40922	60 mm	60 mm	8 -17.52 mm

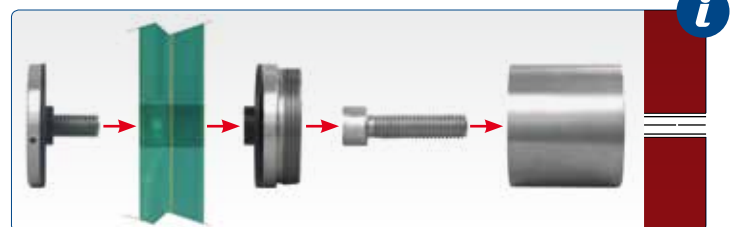



AISI316	D	Outer holes	Central hole
E0700316	∅ 100 x 6 mm	3 x ∅ 9 mm	∅ 13 mm



AISI316	Dimensions	Outer holes	Central hole
E4756	∅ 120 x 6 mm	3 x ∅ 11 mm	∅ 43 mm
E4757	∅ 120 x 6 mm	3 x ∅ 11 mm	∅ 49 mm



AISI304	AISI316	For tube
-	E116316	∅ 42.4 x 2.0 mm
E118	-	∅ 48.3 x 2.0 mm



AISI316	Dimensions	Outer holes	Central hole
E40820	∅ 100 x 16 mm	3 x ∅ 11 mm	∅ 43 mm
E40830	∅ 100 x 16 mm	3 x ∅ 11 mm	∅ 49 mm



AISI316	For tube
E406	∅ 42.4 x 2.0 mm
E406/26	∅ 42.4 x 2.5 mm
E407	∅ 48.3 x 2.0 mm
E407/26	∅ 48.3 x 2.5 mm



AISI316	For tube
E40350/26	∅ 42.4 x 2.5 mm
E40360	∅ 48.3 x 2.0 mm
E40360/26	∅ 48.3 x 2.5 mm



AISI316	Dimensions	For tube
E403	∅ 100 x 6 mm and 3 holes ∅ 11 mm	∅ 42.4 x 2.0 mm
E403/26	∅ 100 x 6 mm and 3 holes ∅ 11 mm	∅ 42.4 x 2.5 mm
E0214316	∅ 100 x 6 mm and 4 holes ∅ 11 mm	∅ 48.3 x 2.0 mm
E0214316/26	∅ 100 x 6 mm and 4 holes ∅ 11 mm	∅ 48.3 x 2.5 mm



AISI316	For tube
E40310	∅ 42.4 x 2.0 mm
E40310/26	∅ 42.4 x 2.5 mm
E40320	∅ 48.3 x 2.0 mm
E40320/26	∅ 48.3 x 2.5 mm



AISI316	Dimensions	Hole	Height
E4072	∅ 105 mm	∅ 43.0 mm	15 mm
E4072/C	∅ 105 mm	∅ 43.0 mm	25 mm
E4073	∅ 105 mm	∅ 49.0 mm	25 mm



AISI316	Dimensions	Hole	Height
X4072	∅ 105 mm	∅ 43 mm	15 mm



AISI316	For tube
E022/S316	Ø 33.7 mm - Ø 42.4 mm

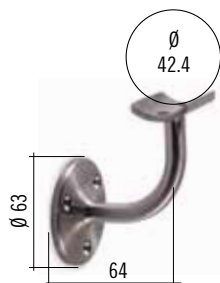

AISI316	For tube
E459	Ø 42.4 mm



Tube adapter with a satin finish

AISI316	For tube	Height H
E491/26	Ø 42.4 x 2.5 mm	12 mm
E492/26	Ø 48.3 x 2.5 mm	14 mm



AISI303	For tube
E038900	Ø 42.4 x 2.0 mm

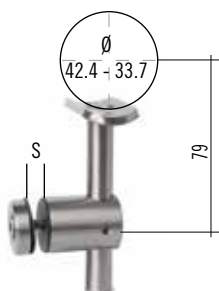

AISI304	AISI316	Description	S
E035200	E035200316	For glass thickness 8-22 mm Glass to be drilled at 21 mm dia.	

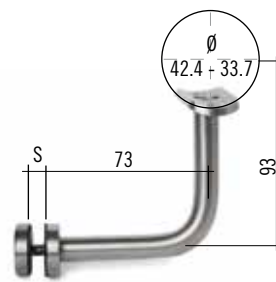

AISI304	Description	S
E035100	For glass thickness 8-22 mm Glass to be drilled at 21 mm dia.	



AISI304	AISI316	For tube
E031/S1	E031/S1316	Ø 42.4 x 2.0 mm
-	E031/S1316/26	Ø 42.4 x 2.5 mm
0312	E0312316	Ø 48.3 x 2.0 mm
-	E0312316/26	Ø 48.3 x 2.5 mm



AISI303	AISI316	For tube
E030/S	E030/S316	Ø 42.4 x 2.0 mm
-	E030/S316/26	Ø 42.4 x 2.5 mm
E0302	E0302316	Ø 48.3 x 2.0 mm
-	E0302316/26	Ø 48.3 x 2.5 mm



AISI304
E0223

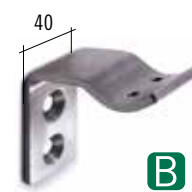

AISI304	Dimensions
E034100	66 x 82 mm



MIRROR POLISHED



3 pieces complete with screws

AISI316	For tube
X031/S1316	Ø 42.4 x 2.0 mm

MIRROR POLISHED



3 pieces complete with screws

AISI316	For tube
X030/S316	Ø 42.4 x 2.0 mm

MIRROR POLISHED

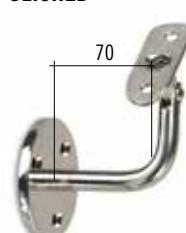

AISI316	For tube
X02231316	Ø 42.4-Ø 43 mm

MIRROR POLISHED

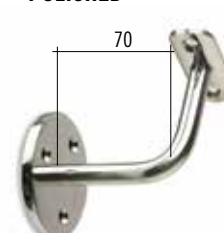

AISI316	For tube
X0223316	Ø 42.4-Ø 43 mm



AISI316	For tube	A
E203	Ø 42.4 x 2.0 mm	50 mm
E203/26	Ø 42.4 x 2.5 mm	50 mm
E2032	Ø 48.3 x 2.0 mm	50 mm
E2032/26	Ø 48.3 x 2.5 mm	50 mm



AISI316	For tube	A
E2035	Ø 42.4 x 2.0 mm	89 mm
E2035/26	Ø 42.4 x 2.5 mm	89 mm
E2037	Ø 48.3 x 2.0 mm	90 mm
E2037/26	Ø 48.3 x 2.5 mm	90 mm



AISI316	For tube	A
E453	Ø 42.4 x 2.0 mm	100 mm
E453/26	Ø 42.4 x 2.5 mm	100 mm
E2042	Ø 48.3 x 2.0 mm	88 mm
E2042/26	Ø 48.3 x 2.5 mm	88 mm



AISI316	For tube	A
E440	Ø 42.4 x 2.0 mm Ø 33.7 x 2.0 mm	



AISI316	For tube	A
E2045	Ø 42.4 x 2.0 mm	87 mm
E2045/26	Ø 42.4 x 2.5 mm	87 mm
E2047	Ø 48.3 x 2.0 mm	91 mm
E2047/26	Ø 48.3 x 2.5 mm	91 mm



AISI316	For tube
E456	Ø 42.4 mm
E2067	Ø 48.3 mm
E2068	Ø 60.3 mm



Satin-finish tube adapter



AISI316	For tube A
E454	Ø 42.4 x 2.0 mm
E454/26	Ø 42.4 x 2.5 mm
E2052	Ø 48.3 x 2.0 mm
E2052/26	Ø 48.3 x 2.5 mm



AISI316	For tube
E5588/26	Ø 48.3 x 2.5 mm

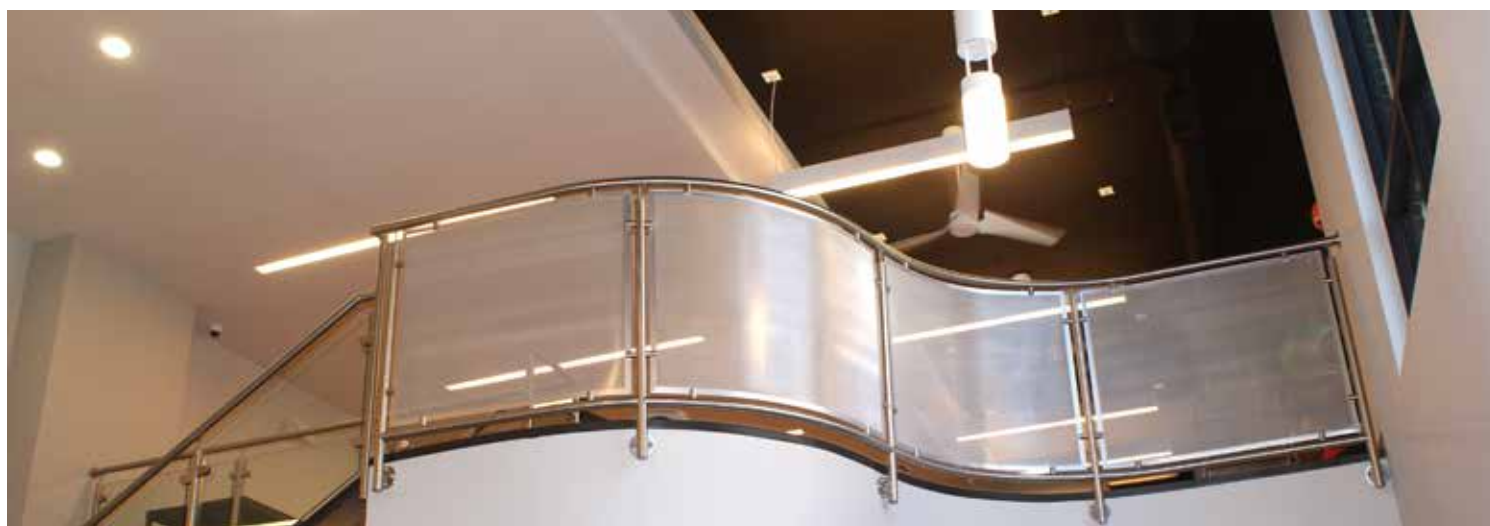



AISI316	For tube	A
E2015	∅ 42.4 x 2.0 mm	50 mm
E2015/26	∅ 42.4 x 2.5 mm	50 mm
E2017	∅ 48.3 x 2.0 mm	55 mm
E2017/26	∅ 48.3 x 2.5 mm	55 mm



AISI316	For tube	A
E451	∅ 42.4 x 2.0 mm	65 mm
E451/26	∅ 42.4 x 2.5 mm	65 mm
E2012	∅ 48.3 x 2.0 mm	67 mm
E2012/26	∅ 48.3 x 2.5 mm	67 mm



AISI316	For tube	
E4561	∅ 42.4 x 2.0 mm	



AISI304	AISI316	For tube	
E455/304	E455	∅ 42.4 x 2.0 mm	
-	E455/26	∅ 42.4 x 2.5 mm	
-	E2062	∅ 48.3 x 2.0 mm	
-	E2062/26	∅ 48.3 x 2.5 mm	



AISI316	For tube	
X455	∅ 42.4 x 2.0 mm	

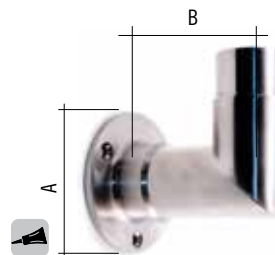

AISI316	For tube	A	B
E4566	∅ 42.4 x 2.0 mm	∅ 84 mm	∅ 80 mm
E4567	∅ 48.3 x 2.0 mm	∅ 95 mm	∅ 85 mm

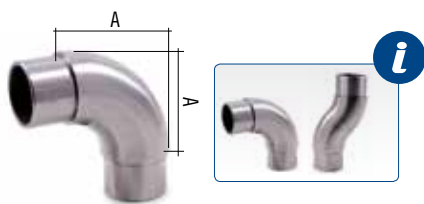

AISI316	For tube	A
E450	∅ 42.4 x 2.0 mm	65 mm
E450/26	∅ 42.4 x 2.5 mm	65 mm
E2002	∅ 48.3 x 2.0 mm	73 mm
E2002/26	∅ 48.3 x 2.5 mm	73 mm



AISI316	For tube	
E4562	∅ 48.3 x 2.0 mm	

AISI316	For tube	A
E447/26	∅ 33.7 x 2.5 mm	59.5 mm
E4471	∅ 42.4 x 2.0 mm	66 mm
E4471/26	∅ 42.4 x 2.5 mm	66 mm
E4472	∅ 48.3 x 2.0 mm	74 mm
E4472/26	∅ 48.3 x 2.5 mm	74 mm
E4473/26	∅ 60.3 x 2.5 mm	83 mm



AISI316	For tube	A
E446	∅ 42.4 x 2.0 mm	53 mm
E4461	∅ 42.4 x 2.5 mm	53 mm
E4462	∅ 48.3 x 2.0 mm	59 mm
E4463	∅ 48.3 x 2.5 mm	59 mm



AISI316	For tube	A
X450	∅ 42.4 x 2.0 mm	65 mm

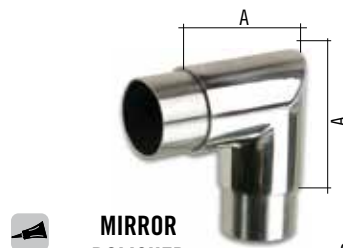

AISI316	For tube	A
X451	∅ 42.4 x 2.0 mm	65 mm

90° angle



AISI303	For tube
E01151	∅ 42.4 x 2.0 mm
E01151/26	∅ 42.4 x 2.5 mm
E01152	∅ 48.3 x 2.0 mm
E01152/26	∅ 48.3 x 2.5 mm



AISI316	For tube	H
E4141	∅ 42.4 x 2.0 mm	9 mm
E4142	∅ 48.3 x 2.0 mm	9 mm



AISI316	For tube
E4110	∅ 42.4 x 2.0 mm



ROUNDED, SOLID END CAPS FOR TUBE



AISI316	For tube	H
E4144	∅ 42.4 x 2.0 mm	9 mm
E011961316	∅ 48.3 x 2.0 mm	10 mm

ROUNDED, HOLLOW END CAPS FOR TUBE



AISI316	For tube	H
E4130/26	∅ 42.4 x 2.5 mm	7 mm
E4136/26	∅ 48.3 x 2.5 mm	7 mm

AISI316	For tube	B x C
E481	∅ 42.4 x 2.0 mm	60 x 80 mm
E482	∅ 48.3 x 2.0 mm	75 x 100 mm

SEMI-SPHERICAL END CAPS

PRESSURE LOCKED END CAPS



Hollow, satin finish



AISI316	For tube
E464/26	∅ 33.7 x 2.5 mm
E465	∅ 42.4 x 2.0 mm
E465/26	∅ 42.4 x 2.5 mm
E466	∅ 48.3 x 2.0 mm
E466/26	∅ 48.3 x 2.5 mm
E467/26	∅ 60.3 x 2.5 mm



AISI316	For tube	Tube thickness
E316	∅ 42.4 mm	1.5 - 2.5 mm
E317	∅ 48.3 mm	1.5 - 2.5 mm



AISI316	For tube	H
E4120	∅ 42.4 x 2.0 mm	9 mm
E4120/26	∅ 42.4 x 2.5 mm	9 mm
E4135/26	∅ 48.3 x 2.5 mm	9 mm



MIRROR POLISHED



AISI316	For tube
X465	∅ 42.4 x 2.0 mm



AISI316	For tube
E452	∅ 42.4 x 2.0 mm

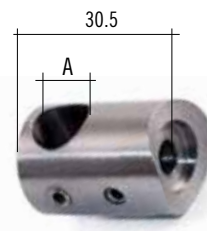

AISI316	For tube	Hole A
E4040	∅ 42.4 mm	∅ 14.2 mm through
E4041	∅ 48.3 mm	∅ 12.2 mm through
E4044	Flat face	∅ 12.2 mm through

Hexagon socket countersunk flat head screw
UNI 5933 / DIN 7991

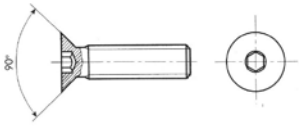

AISI316	Thread
E0385316	M5 x 25

Hexagon socket head cap screw
UNI 5931 / DIN 912 / ISO 4762

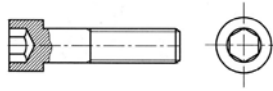

AISI316	Thread
E0323316	M8 x 20

Cross recessed countersunk flat head screw (for wood) DIN 7505A



AISI316	Thread
E0382316	5 x 20

PRODUCTS TO CLEAN STAINLESS STEEL



Passivating paste that helps to create a protective coating on stainless steel

Art. no.
E4051



Protective spray that leaves an anti-static and water repellent finish

Art. no.
E4052



High strength adhesive

Art. no.
E4054



Cleaning solution formulated to remove rust spots from the surface of stainless steel and return the material to its original finish

Art. no.
E4052/D



Passivating paste that helps to create a protective coating on stainless steel

Art. no.
E4052/P

HOW TO TREAT OXIDISED STAINLESS STEEL

Stainless steel is an extremely durable material, however, occasional maintenance is recommended to retain its appearance and prevent 'rust spotting' or staining. Aalco offers a range of specially-developed cleaning agents that, when used, will extend the life and preserve the appearance of stainless steel.



Example of a stainless steel picket polluted by external agents like dust and smog



Application of the de-rusting product E4052/D: all polluted parts must be covered



Application of the passivating product E4052/P: the polluted component must entirely be covered



Result of the application of Ind.i.a. spa's de-rusting and passivating products

PRODUCT TO BE GLUED WITH E4054

PLASTIC HAMMER TO BE USED

TESTED FOR A RESISTANCE OVER 3 kN/m **3kN**

ANTI-CLIMB PRODUCT

PRODUCT TO BE WELDED SUPER STRONG, HIGH RESISTANCE PRODUCT **S**

TESTED FOR A RESISTANCE OVER 2 kN/m **2kN**

POWDER COATED, DIFFERENT COLOURS AVAILABLE UPON REQUEST

ASSEMBLY WITH ALLEN KEY BEST PRICED PRODUCT IN THE RANGE **B**

NEW PRODUCT **NEW**

Birmingham

October 11th to 15th
2017

**GRAND
DESIGNS
LONDON** **LIVE**

www.aalco.co.uk
www.iamdesign.com

ABERDEEN

Tel 01224 854810
Fax 01224 871982
e-mail aberdeen@aalco.co.uk

ESSEX

Tel: 01268 884200
Fax: 01268 884220
email: essex@aalco.co.uk

NEWCASTLE

Tel 0191 491 1133
Fax 0191 491 1177
e-mail newcastle@aalco.co.uk

AYLESBURY

Tel 01296 461700
Fax 01296 339923
e-mail aylesbury@aalco.co.uk

GLASGOW

Tel 0141 646 3200
Fax 0141 646 3260
e-mail glasgow@aalco.co.uk

NORWICH

Tel 01603 787878
Fax 01603 789999
e-mail norwich@aalco.co.uk

BELFAST

Tel 028 9083 8838
Fax 028 9083 7837
e-mail belfast@aalco.co.uk

HULL

Tel 01482 626262
Fax 01482 626263
e-mail hull@aalco.co.uk

NOTTINGHAM

Tel 0115 988 2600
Fax 0115 988 2636
e-mail nottingham@aalco.co.uk

BIRMINGHAM

Tel 0121 585 3600
Fax 0121 585 7837
e-mail birmingham@aalco.co.uk

LEEDS

Tel 0113 276 3300
Fax 0113 276 0382
e-mail leeds@aalco.co.uk

SOUTHAMPTON

Tel 023 8087 5200
Fax 023 8087 5275
e-mail southampton@aalco.co.uk

CHEPSTOW

Tel 01291 638638
Fax 01291 638600
e-mail chepstow@aalco.co.uk

LIVERPOOL

Tel 0151 207 3551
Fax 0151 207 2657
e-mail liverpool@aalco.co.uk

STOKE

Tel 01782 375700
Fax 01782 375701
e-mail stoke@aalco.co.uk

DYFED

Tel 01269 842044
Fax 01269 845276
e-mail dyfed@aalco.co.uk

MANCHESTER

Tel 01204 863456
Fax 01204 863430
e-mail manchester@aalco.co.uk

SWANLEY

Tel 01322 610900
Fax 01322 610910
e-mail swanley@aalco.co.uk



Also available
in Ireland

DUBLIN

Tel +353 (0) 1 629 8600
Fax +353 (0) 1 629 9200
e-mail:dublin@amari-dublin.com

CORK

Tel +353 (0) 21 431 0520
Fax +353 (0) 21 431 0519
e-mail:cork@amari-cork.com